

Lindam

booster seat

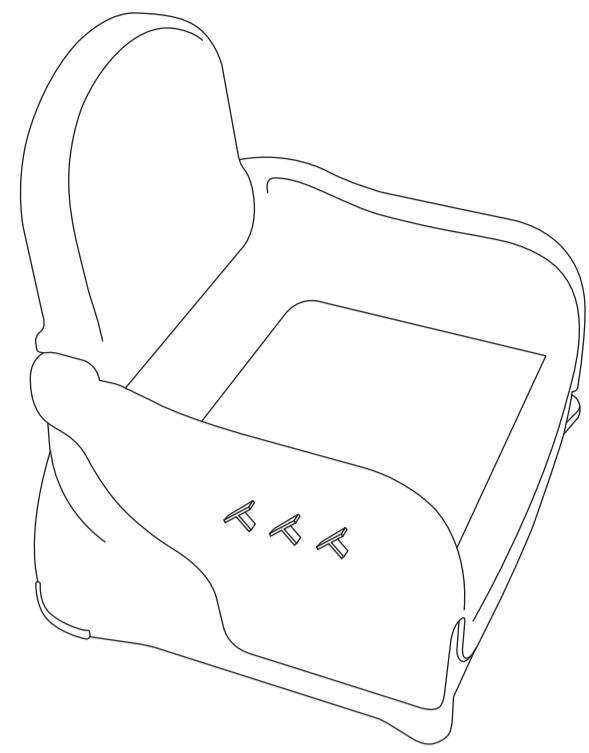

IMPORTANT! KEEP FOR FUTURE REFERENCE

THIS BOOSTER SEAT IS SUITABLE FOR CHILDREN BETWEEN THE AGES OF 12 MONTHS AND 3 YEARS
 customer careline 08701 118 118 (Mon - Fri, 10am - 4pm, UK only)
 Lindam Limited Hornbeam Park Harrogate HG2 8PA England www.lindam.com
 product code: 44464

8

SETTING UP YOUR SEAT

Lift up the back to your seat. Once in place push it downwards until it snaps in to position.

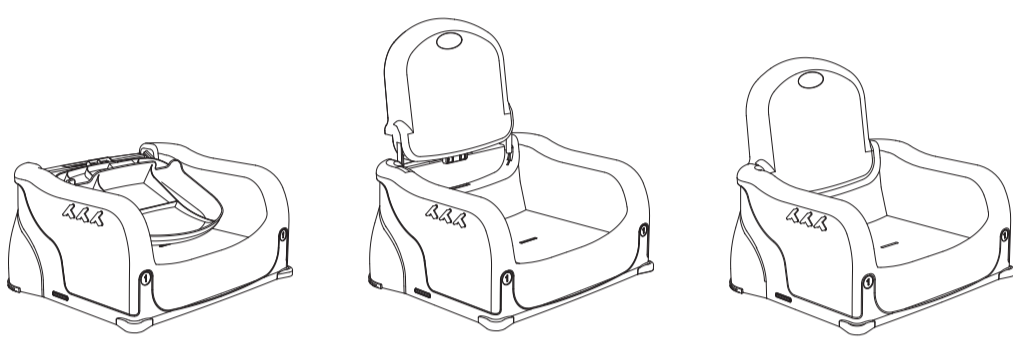

For easy storage this action can be reversed.

IMPORTANT! Please inspect your Lindam booster seat before each use for damage or broken parts. All replacements are available from Lindam only. Do not use substitute parts.

CARE

The booster seat with attached straps and belts may be wiped clean using a mild cleaning solution and a damp cloth. Do not use bleach. Do not use harsh or abrasive cleaners. Rinse clean with water to remove residue.

The tray is top shelf dishwasher safe at 65°C maximum.

IMPORTANT! Inspect this product before each use for damage, loose and missing parts or sharp edges.

DO NOT use if parts are missing or broken. Contact Lindam for replacement parts and instructions if needed.

WARNINGS

To prevent serious injury from falls or sliding out:

- Always secure child with the belts until child is able to get in and out of the booster seat independently and safely. The tray is not designed to hold child in the chair; never rely on the tray to restrain child
- Never leave child unattended
- Always secure booster seat on chair using both attachment straps
- Never use the booster seat on a stool or bench that does not have a seat back.
- To be used exclusively on a chair with seat dimensions greater than those of the booster seat
- Check that the floor and chair seat are level before installing the booster seat
- Do not use on stools, unstable or folding chairs.

2

ATTACHING YOUR TRAY

Make sure your child is fully secure in the booster seat before attaching the tray.

The tray should be attached to two tabs on the arm rest at any one time as illustrated. Do not attach to only one button as the tray may not be secure

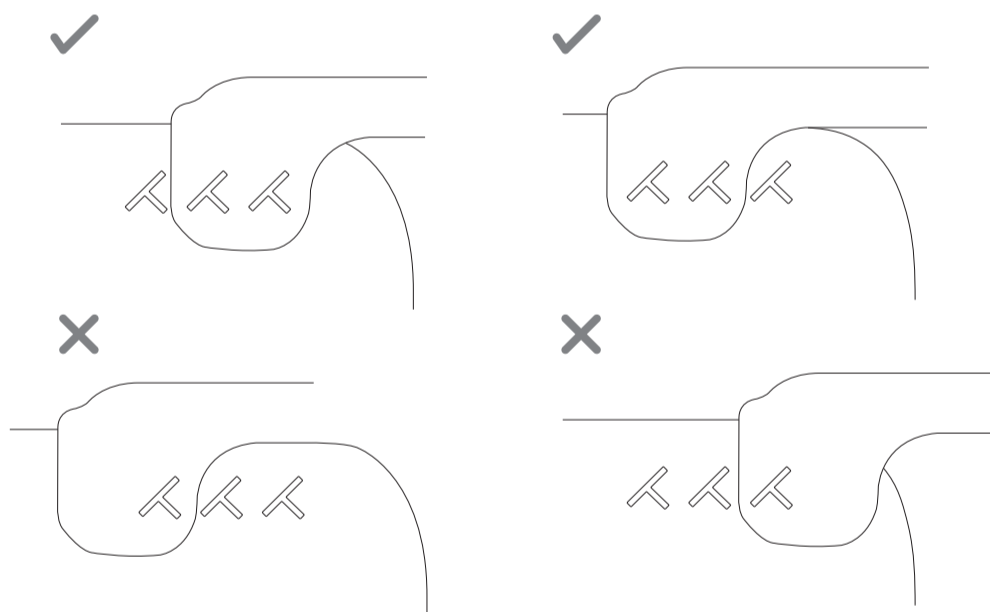

To remove the tray from the booster seat simply loosen the tray from the tabs and lift.

7

ADJUSTING THE SEAT HEIGHT

This Booster Seat has two height positions which are selected using the Handle at the rear. You will receive the seat in its lowest position. To raise the height of the chair simply Lift and Push the handle forwards (currently in the Lower Opening) to release the seat portion from the base. Raise the seat portion 4cm and slide it backwards to locate the handle in the Upper Opening. The Handle will 'click' into place. Always check that your Seat is secure!

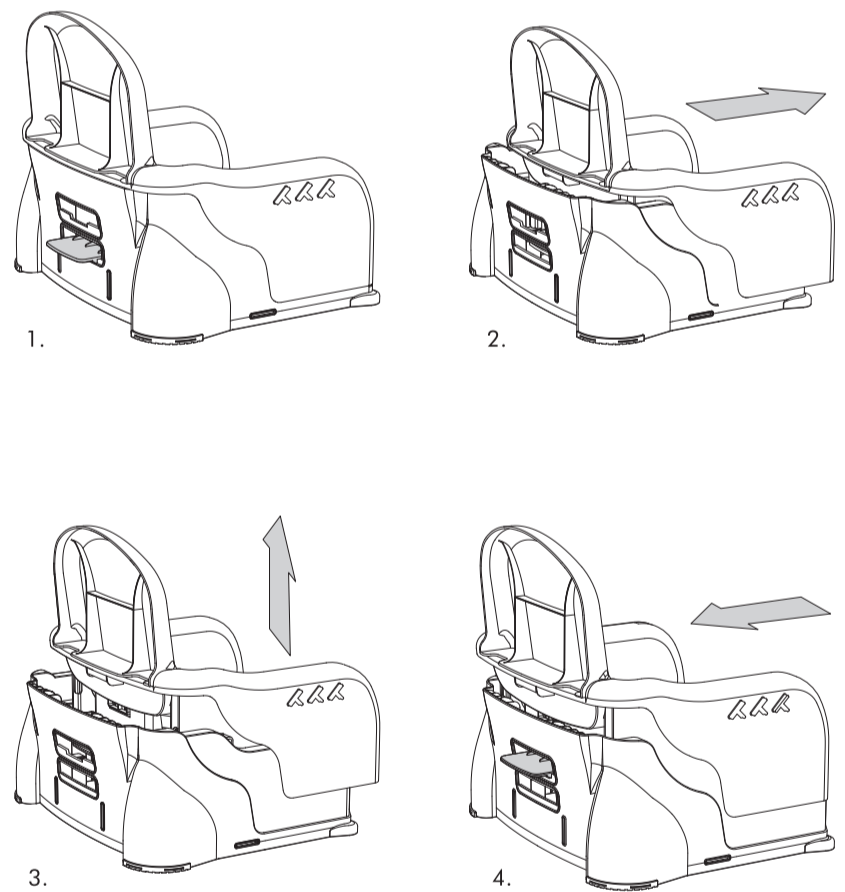

NOTE: This may alter your harness settings. Harness may need to be adjusted as on page 5.

6

ATTACHING TO A CHAIR

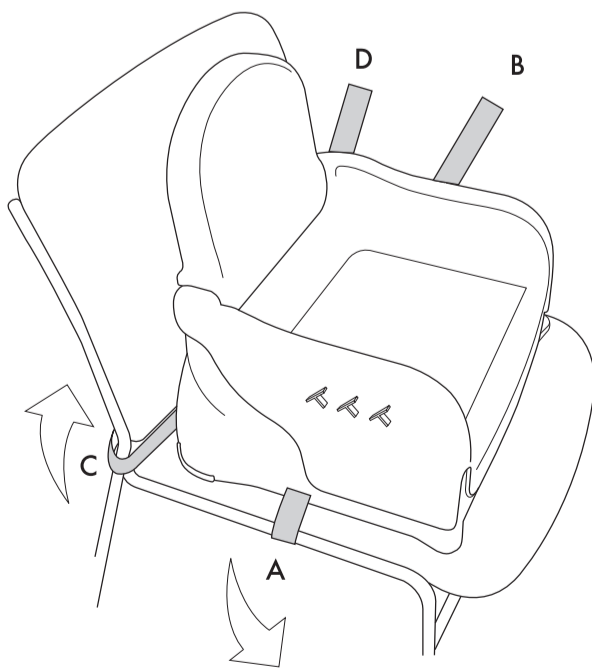

A attaches to B underneath the chair

C attaches to D behind your chair

This is by the following mechanism:

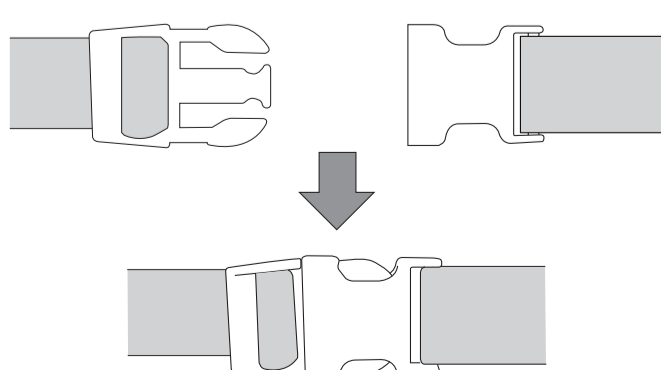

Make sure you hear the 'click'. Pull the free end of the strap to tighten on the chair.

4

3

SECURING YOUR CHILD

Your child can be secured using the three point harness. Make sure you hear a 'click'.

To tighten the harness belts, feed the free end of the harness belt up through the buckle to form a loop. Pull the free end of the harness to secure.

Check the harness by pulling away from your child. It will remain intact.

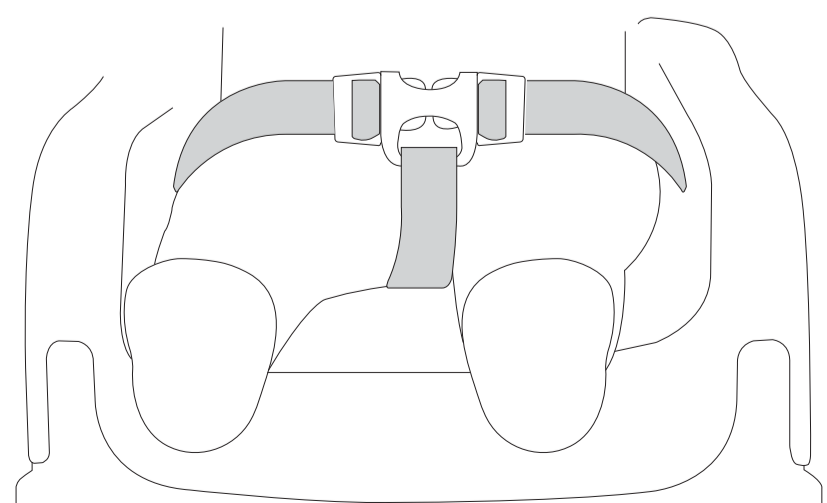
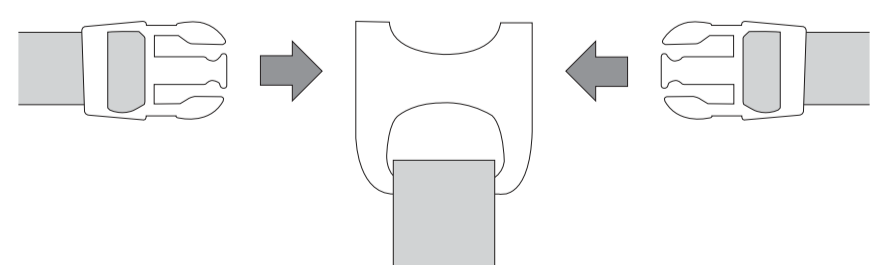

5